

Dealer Price List

Prices Effective January 1, 2008



Electric Glass Washers



Item No	Product Description	Shipping Weight	List Price Each
A-200	UPRIGHT GLASS WASHER - 115V-60Hz Features quiet, powerful 1/3 HP enclosed motor with sealed lower bearing and exclusive Splashgard canopy. Heavy bronze bearings and stainless construction. Available with factory installed G.F.C.I. Details on request.	27 Lbs each unit	564.10
A-205	UPRIGHT GLASS WASHER - 220V-50/60Hz		608.60
SS-100	SUBMERSIBLE GLASS WASHER - 115V-60Hz Powerful 1/3 HP motor, heavy-duty stainless construction and bronze bearings deliver outstanding performance and reliability. G.F.C.I. included.	27 Lbs each unit	725.60
SS-101	SUBMERSIBLE GLASS WASHER - 220/230V - 50Hz/60Hz		769.00

Replacement Brush Sets

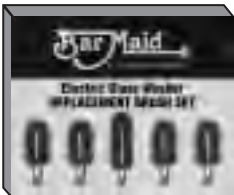

Item No	Product Description	Single Unit List \$
BRS-1722	BAR MAID 4 X 6" & 1 X 7 1/2" Original Replacement Set in a bar coded retail display box.	76.40
BRS-1720SL	UNIVERSAL 4 X 6" & 1 X 6 3/4" Replacement Set fits all current models in a bar coded retail display box.	76.40

Manual Glass Washers



Item No	Product Description	Single Unit List \$	Case List \$
GWM-200	TWO BRUSH MANUAL GLASS WASHER Bar Maid Heavy Duty Manual Glass Washers Feature Long Lasting Brushes and Firm Grip Suction-cup Base. Packaged in Bar Maid Color Display Packaging.	25.40	152.40 (6 per case)
GWM-300	THREE BRUSH MANUAL GLASS WASHER	31.40	188.40 (6 per case)
GWM-100	REPLACEMENT BRUSHES for Manual Glass Washers	10.80	129.60 (12 per case)

Freight Policy

PLEASE NOTE: Pre-paid freight applies to shipment weight only and not to other services. Charges levied by carriers for delivery appointments, driver assistance, etc., are the responsibility of the purchaser.
Glass Washers - 50% of freight cost paid on orders of a minimum of 3 Electric Glass Washers shipped within the contiguous USA - 100% of freight cost paid on orders of a minimum of 6 or more Electric Glass Washers shipped within the contiguous USA.
Replacement parts - including Glass Washer replacement brushes, KP Carts, KP Dollies, Manual Glass Washers, Pre-Scrubbers, Sanitizer and Test Strips have no freight allowance and are not prepaid EXCEPT when accompanying orders of 6 or more Electric Glass Washers.
Lo Suds & Sanitizer- Lo Suds cases and Sanitizer Master Cartons mix or match - 25% paid on 25 - 75 cases, 50% paid on 76+ cases - shipped within the contiguous USA.



DEALER PRICING

Prices are subject to change without notice.
 Minimum order size is \$30.00.
 Parts orders are FOB Pompano Beach, FL.
 Pre-paid freight applies to shipment weight only and not to other services.
 Charges levied by carriers for delivery appointments, driver assistance, etc., are the responsibility of the purchaser.



ALL MODELS TESTED AND APPROVED FOR SAFETY AND SANITATION IN THE USA AND CANADA
 ANSI/UL 921 CSA C22.2 NO 168M NSF-26

Order Line 1-800-526-5278 • Order Fax 1-800-457-5612 • Email: info@barmaidwashers.com



Glass Washer Parts List

Part Number	Product Description	Model SS Diagram #	Model A Diagram #	Qty Required	List \$ Each
BAN-865	BAND • gear protector for Model A and SS	1	2	1	25.60
BER-3540S	BEARINGS SET • upper and lower shaft bearing set for Model A	N/A	3 & 4	1 set	11.90
BER-860	BEARINGS • bronze gear bearings for Model A and SS	2	5	12	8.60
BER-860S	BEARINGS SET • bronze gear bearing set (12 per set) for Model A and SS	2	5	1 set	94.00
COR-115	CORD or • with switch assembly & GFCI for Model SS (older model)	7	N/A	1	110.00
COR-120	CORD • with switch assembly (no GFCI) for Model SS (older model)	7	N/A	1	70.00
COR-125	CORD • with switch assembly and GFCI for Model SS (new style)	N/A	9	1	18.30
COR-220	CORD • with strain relief for Model A	N/A	10	1	19.90
CPL-285	COUPLER • motor shaft for Model A	N/A	17	1	18.00
CPY-500	CANOPY • Splashgard® for top of motor on Model A	8 & 24	12 & 24	1 set	12.90
FET-850Set	FEET SET • 4 black rubber feet with 4 screws for Model A and SS	not shown	not shown	1	62.60
FPL-1070	FOOT PEDAL SWITCH • accessory for Model A and SS	N/A	11	1	3.30
GAS-175	GASKET • drive gears (to drive the brushes) for Model A and SS	9	13	5	10.90
GER-905	GEARS • idler gear for Model A and SS	10	14	1	10.90
GER-906	GEAR SET • 5 drive gears and 1 idler gear for Model A and SS	9 & 10	13 & 14	1 set	59.90
GFI-100	G.F.C.I. • ground fault interrupter safety device	7(a)	N/A	1	57.00
MTR-201	MOTOR • Model A-200 (115V) W/cord, switch & canopy	N/A	16	1	236.00
MTR-205	MOTOR • Model A-205 (220V - 50/60Hz)	N/A	16	1	250.00
MTR-801	MOTOR • Model SS (115V) with switch and G.F.C.I.	13	N/A	1	348.00
MTR-830	MOTOR • Model SS (220-230V - 50/60Hz) with switch	13	N/A	1	399.00
PLT-101	PLATE • top plate for Model SS	14	N/A	1	128.00
PLT-102	PLATE • bottom plate for Model A and SS	15	19	1	121.00
PLT-201	PLATE • top plate for Model A	N/A	18	1	131.60
PPP-185	PLASTIC PLUG • for bottom plate for Model SS	16	N/A	1	2.40
SBA-270	SWITCH COVER • switch cover - red for Model A	N/A	27(a)	1	2.80
SBC-230	SWITCH COVER • switch cover with nut for Model SS	18	N/A	1	7.30
SBX-110	SWITCH BOX • without switch for Model SS	17	N/A	1	11.00
SCR-150	SCREW • back plate - square head (old) for Model SS	20	N/A	1	2.60
SCR-875	SCREW • plate screw (old) for Model A and SS	23	23(a) (b)	SS=13 A=16	1.60
SCR-876/877	Through Bolt / Nut Assembly • Includes Spacer (black not threaded) for Model A and SS	23	23	SS=6 A=9	5.20
SCR-878/879	Screw / Lock Nut • Smaller for white spacer at back hole of plate for Model A and SS	20	23(a) (b)	1	2.70
SHF-135	SHAFT • drive shaft pinion gear for Model SS (Includes Screw SCR-145)	25	N/A	1	26.50
SHF-245	SHAFT • drive shaft for Model A	N/A	25	1	66.10
SPA-885	SPACER • plate spacer White	26	26	SS=7 A=9	2.50
SPA-886	SPACER • plate spacer, black unthreaded (use with throughbolt/nut) for Model A and SS	26	26	SS=7 A=9	2.50
SWA-150	SWITCH ASSEMBLY • includes an "O" ring, switch, switch boot, switch box, 4 bottom and 2 side screws, and 2 terminals for Model SS	17	N/A	1	36.30
SWA-250	SWITCH ASSEMBLY • includes a switch, switch boot and a bushing for Model A	N/A	20	1	17.60
SWB-197	SWITCH BUSHING • for Model A	N/A	27	1	2.20
SWT-196	SWITCH • heavy duty 20 amp toggle switch for Model A	N/A	27	1	13.50
SWT-200	SWITCH • heavy duty switch, cover and connectors for Model SS	18(a)	N/A	1	18.00

Bar Maid heavy-duty
1/3 HP replacement
motors fit all makes
of Glass Washers.



Powerful 1/3 HP motor, heavy-duty stainless construction and bronze bearings deliver outstanding performance and reliability. G.F.C.I. included. ETL approved to UL, CSA & NSF.

**Model SS-100
Model SS-101
Submersible
Glass Washer**

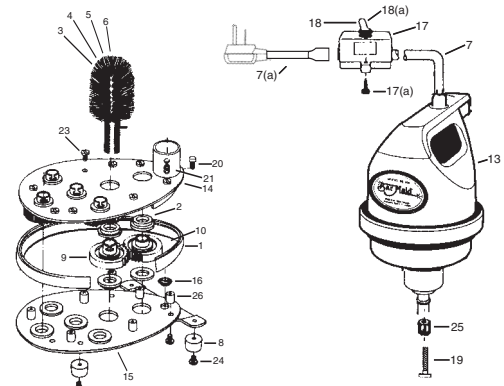

Order Line 1-800-526-5278 / Order Fax 1-800-457-5612

Part Number	Product Description	For Glass Washer Models	Qty Required	List \$ Each
BRS-917	6 INCH • standard replacement brush	Model A & Model SS	5	15.30
BRS-917S	6 INCH SOFTIE® • for delicate glassware	Model A & Model SS	5	15.70
BRS-920	6 3/4 INCH • for slightly taller glassware	Model A & Model SS	1	16.40
BRS-922	7 1/2 INCH • for taller glassware	Model A & Model SS	1	16.80
BRS-975	8 1/2 INCH • for extra tall glassware	Model A & Model SS	1	23.90
BRS-976	9 INCH • Pilsner	Model A & Model SS	1	24.80
BRS-930	COFFEE POT & PITCHERS • for wide coffee pots and pitchers	Model A & Model SS	1	29.60
BRS-935	COFFEE POT • for narrow top coffee pots	Model A & Model SS	1	29.60
BRS-950	MARGARITA • Margarita & Martini glasses	Model A & Model SS	1	20.60
BRS-980	MUFFIN PAN • 4 inch scrub brush	Model A & Model SS	4	18.60
Universal Brush	Perfect Fit In All Brands Of Glass Washers (except Waring®)			
BRS-917SL	6 INCH Slotted Brush • universal standard replacement	Competitive Brands and Model A & Model SS	5	15.90
BRS-920SL	6 3/4 INCH Slotted Brush • universal slightly taller replacement	Model A & Model SS	1	16.90
BRS-922SL	7 1/2 INCH Slotted Brush • universal taller center brush	Model A & Model SS	1	17.90
Special Sizes	Baby Bottle, and Other Sizes Available	Model A & Model SS	—	Special
BPI-890	BRUSH PINS • locking pins for Bar Maid brushes	Model A & Model SS	1 per brush	.60
BRS-1722	BRUSH SET REPLACEMENT • Bar Maid 4 x 6" & 1 x 7 1/2"	Model A & Model SS	1	76.40
BRS-1720SL	BRUSH SET REPLACEMENT • Universal 4 x 6" & 1 x 6 3/4"	Bar Maid & Competitors	1	76.40

Please Note: Brush size is the "useable" length of the brush.



BRS-930



BRS-935



BRS-950



BRS-980



BRS-917SL, BRS-920SL
BRS-922SL



**Model A-200
Model A-205
Upright
Glass Washer**

Features quiet, powerful 1/3 HP enclosed motor with sealed lower bearing and exclusive Splashgard® canopy. Heavy bronze bearings and stainless construction. ETL approved to UL, CSA & NSF.

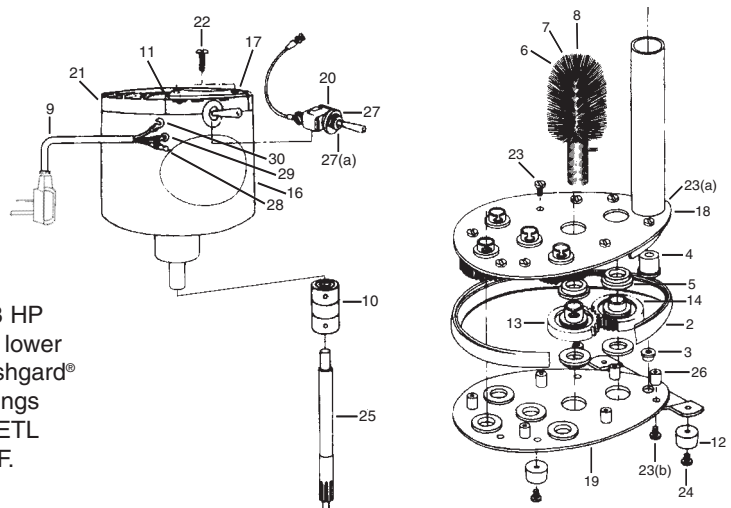

Order Line 1-800-526-5278 / Order Fax 1-800-457-5612



LoSUDS & Sanitizer

Item No	Product Description	Shipping Weight	Quantity	List Price Unit	List Price Carton
DET-200	LoSUDS – The ultimate detergent. For electric Glass Washers – use only 1 ounce per 3 gallons of water	37 lbs.	4/1 gallons per case	13.55 per Gallon	54.20 Case
DIS-201	Bar Maid Quaternary Tablet Sanitizer . Kitchen and Bar, 3rd sink & surface. One Tablet per gallon – 150 tablets per bottle (12 cases per master carton)	47 lbs.	6 bottles per case	44.80 per Case	537.60 Master Carton
DIS-202	Bar Maid Sanitizer Test Strips - Quaternary Strips Convenient dispenser stops wet fingers from damaging unused strips. Approximately 100 test strips per dispenser, 12 dispensers per display box	1 lb.	12 dispensers per box	8.80 per Dispenser	105.60 Box of 12
DIS-302	Bar Maid Sanitizer Test Strips - Chlorinated Strips Convenient dispenser stops wet fingers from damaging unused strips. Approximately 100 test strips per dispenser, 12 dispensers per display box	1 lb.	12 dispensers per box	6.00 per Dispenser	72.00 Box of 12



Keg & Pail Cart & Dolly

Item No	Product Description	Shipping Weight	Quantity	List Price Each
KPC-100	KP CART - Keg & Pail Cart. Easily moves heavy kegs, stock pots, 5 gallon pails etc.	20 lbs.	1 per box	263.20
DOL-100	KP DOLLY - Keg & Pail Dolly. Heavy duty all metal construction moves beer kegs and most sizes of trash cans. Supports up to a maximum of 400lbs.	7 lbs.	1 per box	98.80



Glass Washer - Pre-Scrubber

Item No	Product Description	Shipping Weight	Quantity	List Price Each
GWM-1	PRE-SCRUBBER - Manual Glass Washer. Easily removes lipstick etc. before glasses go in cabinet washer. Also can be used as back up Glass Washer.	2 lbs.	1 per box	54.00

Bar Maid Corporation

2950 N.W. 22nd Terrace • Pompano Beach, FL 33069-1045
 Tel: (954) 960-1468 • Fax: (954) 960-1647 • email: info@barmaidwashers.com